



AMG9I(H)M2 Series Managed Ethernet Switch With PoE Quick Start Guide



1

FIXINGS



DIN RAIL

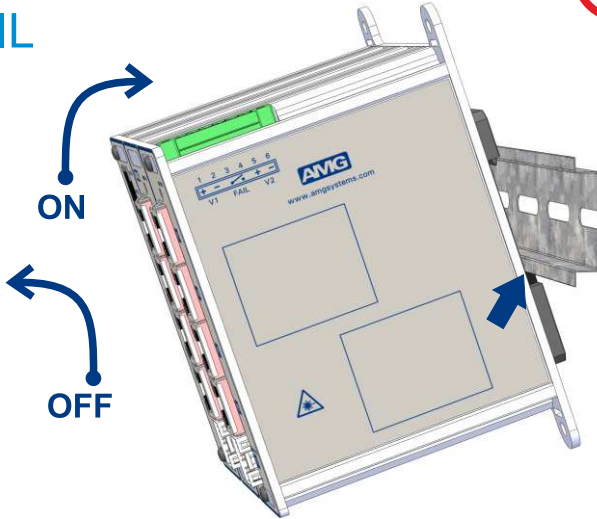

HARD SURFACE MOUNT

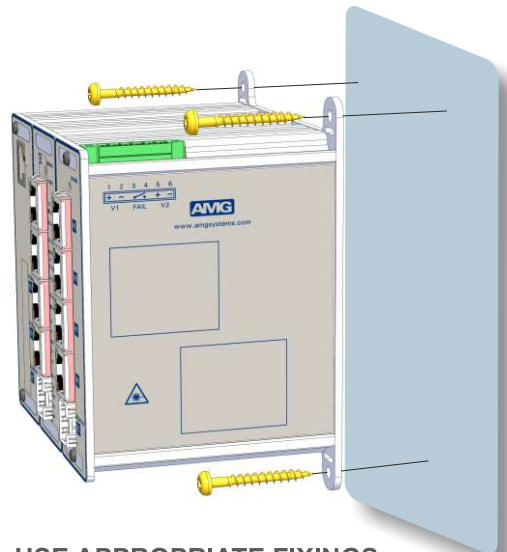
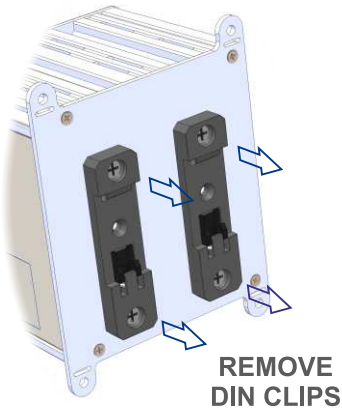

USE APPROPRIATE FIXINGS
(not supplied)

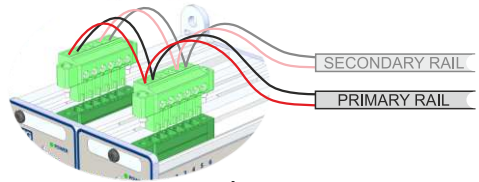
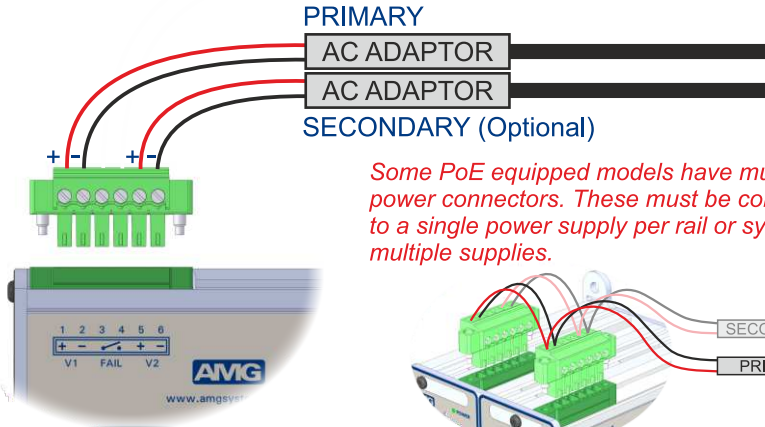

Power Supply		Power
PoE	48-56VDC	15W*
PoE+	56VDC	30W*
PoE 60	56VDC	60W**
PoE 95	56VDC	95W**



Warning
Do not exceed
rated voltage

* Per Port

** Marked Ports Only

SFP Installation

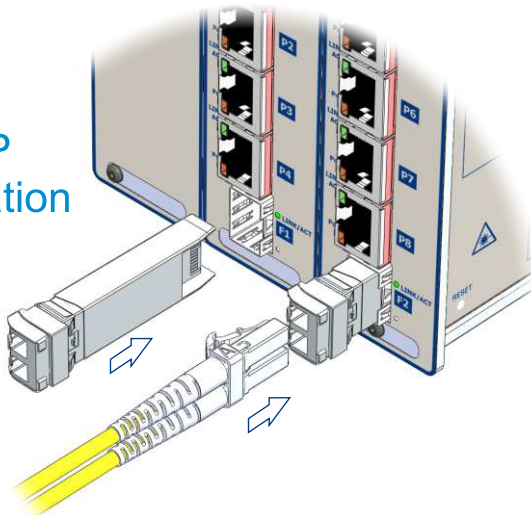

CONNECTIONS (Data Models)

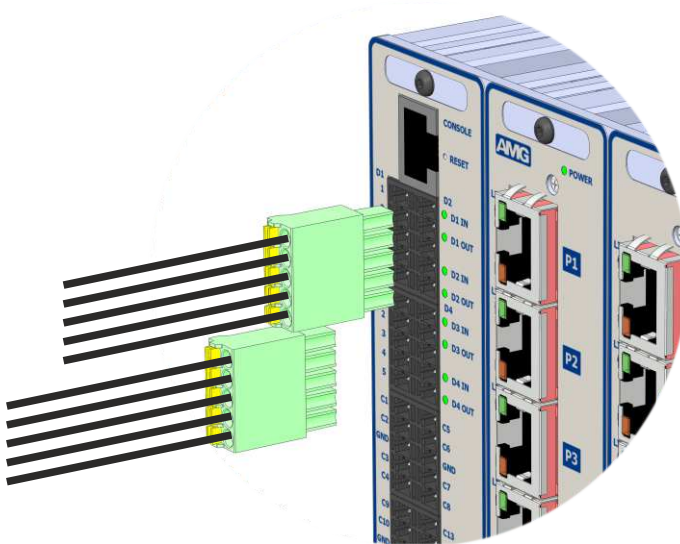

DATA CONNECTIONS PORTS D1-D4

PIN NUMBER	RS-422	RS-422	RS-422
1	Data OUT - (B)	Data IN/OUT - (B)	Data OUT (Tx)
2	Data OUT + (A)	Data IN/OUT + (A)	
3	GND	GND	GND
4	Data IN - (B)		
5	Data IN + (A)		Data IN (Rx)

Typical Contact Closure Input
C1-C16

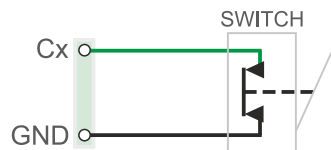

**DO NOT EXCEED 24V dc
ON CONTACT CLOSURE PORTS**

Typical Contact Closure Output
C1-C16

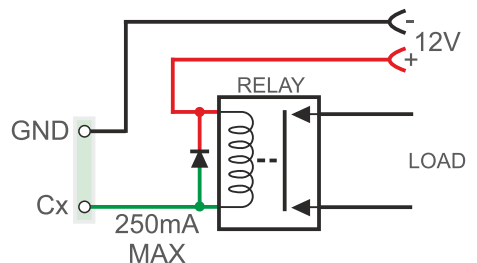

Port modes must be configured in software
See user manual for full configuration data

3

CONFIGURATION

RS232 Connections

Console	TX-Out	RX-In	Gnd	No Connection
RJ45	2	3	5	1,4,6,7,8
DB9	2	3	5	1,4,6,7,8,9

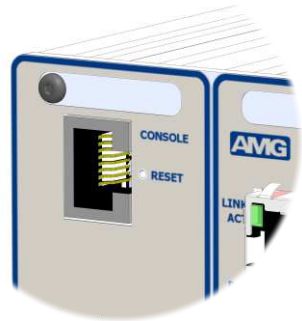
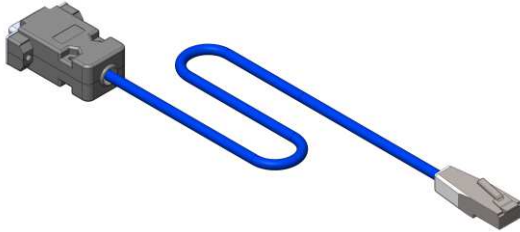

Command Line Interface

Connect using a terminal application such as PuTTY or HyperTerminal:
Serial COM Port, Speed 115200
Default logon "Admin" Password "Admin"

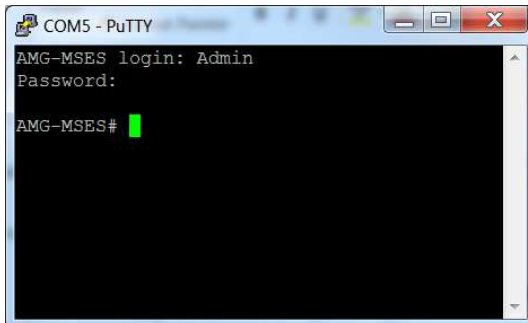
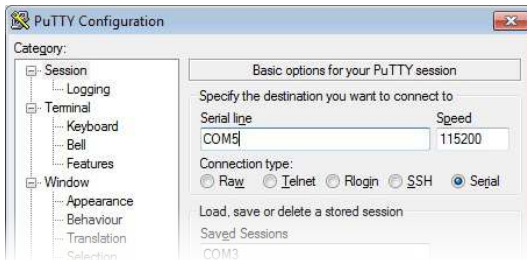

NETWORK GUI LOGON

Connect using a compatible browser e.g. IE 11.0 or Firefox

Default IP Address 192.168.1.101

Default User Name Admin

Default Password Admin

AMG-MSES LOGIN

User Name:

Password :



[Support](#) [Help](#) [About](#) [Log Out](#)

P1 P3 P5 P7 F1

P2 P4 P6 P8 F2

P1 P3 P5 P7 F1

P2 P4 P6 P8 F2

M-SES

Home

- System
- Layer2 Management
- IP Management
- Multicast
- i/o
- Statistics

AMG-MSES2

The AMG-MSES2 solution offers layer2 switching at wire speed and addresses the enterprise needs for constructing a switched network. The solution not only has the required features for providing the bridging functionality, but also comes with advanced features such as link aggregation, Dynamic Vlan/Dynamic Multicast, IGMP Snooping and Network Access Control.

This page is best viewed with 1024x768 resolution.

4

SPECIFICATIONS

MODEL	ETHERNET	SFP	Operating Temperature
AMG9IM2-xF-xS	100 Mbps	100 Mbps	-10°C to 60°C
AMG9IM2-xG-xS	10/1000 Mbps	10/1000 Mbps	-10°C to 60°C
AMG9HM2-xF-xS	100 Mbps	100 Mbps	-40°C to 75°C
AMG9HM2-xG-xS	10/1000 Mbps	10/1000 Mbps	-40°C to 75°C

Power Supply:

PoE..... 48 - 57VDC (DC Isolated)
 PoE+..... 54 - 57VDC (DC Isolated)
 PoE60/95..... 56 - 57VDC (DC Isolated)

Power Requirement:

PoE + 15 Watts* max (12.5W max load)
 PoE+..... + 30 Watts* max (25W max load)
 PoE60..... + 60 Watts* max (52W max load)
 PoE95..... + 95 Watts* max (80W max load)

** Per port*

Physical:

Mounting.....DIN Rail or Surface Mount
 Dimensions.... A x 85 x 112mm (W x D x H)
 Weight.....B

Case Style	7HP	14HP	21HP	28HP
A	35mm	71mm	107mm	142mm
B	300g	500g	700g	900g

Environmental:

Operational Temperature.....See table above
 Storage Temperature..... -40°C to 80°C
 Humidity.....5% to 90% (non-condensing)

Approvals:
 CE, RoHS

