

AMG350-8G SERIES INDUSTRIAL UNMANAGED SWITCHES WITH OPTIONAL 30W POE



Industrial Ethernet Solutions

AMG's unmanaged Ethernet switches provide 100Mbps or Gigabit Ethernet switching for simple edge network applications with optional 30W PoE. Available with 8x Gigabit RJ45 ports.



 Gigabit up to x8	 Gigabit up to x8	 Temp -40°C~+75°C	 Mounting DIN/Surface	 PSU x2 Dual	 Protection IP40	 NDA/TAA Compliant
---	---	---	---	--	--	--

[AMG350-8G Series]

/ OVERVIEW

Designed in a compact DIN rail or wall mount housing, the AMG350 series unmanaged Ethernet switches are ideally suited for connecting edge devices to Ethernet networks where more complex management functions are not required.

Available in both non-PoE models as well as PoE models for IEEE802.3at 30W they are suitable for powering PoE devices over a wide industrial operating temperature range.

Fitted with dual redundant power inputs and power failure alarm relay ensures maximum operating reliability and the highest levels of performance.

A wide range of models are available in the AMG350 product range to suit all unmanaged switch design requirements.

PSUs need to be ordered separately.

/ FEATURES

- Compact size – ideal for confined spaces, including camera poles and roadside cabinets
- Innovative thermally efficient housing ensures high levels of device reliability under full load
- -40°C to +75°C temperature maintains performance in extreme conditions
- Plug & Play – no need for any user configuration
- DIN rail mountable – quick to install and remove for maintenance
- Dual redundant power inputs with fault relay
- Supports optional 15W and 30W PoE
- Auto-Negotiation (802.3u) – automatically determines the best connection speed
- Designed in the USA & UK. Manufactured in the United Kingdom
- AMG Lifetime Support Warranty

Specifications.

Standards.

IEEE802.3i	10Base-T
IEEE802.3u	100Base-TX
IEEE802.3ab	1000Base-T
IEEE802.3af	15W PoE
IEEE802.3at	30W PoE+
IEEE802.3x	Flow Control

Jumbo Frames	9.6Kbytes
Address Table	4K MAC Entries
Switch Fabric	16 Gbps
Buffer Memory	1M bits

Interface.

LED Indicators	2x Power RJ45 Link/Activity PoE (PoE Models Only)
RJ45 Ports	8x 10/100/1000T(X) RJ45 with Auto MDI/MDI-X with 2 kV Isolation Protection
Power/Relay	1x 6-way removable terminal block with locking screws

Power.

Power Inputs	2
Operating Voltage:	
Non-PoE Models	12-56V _{DC}
30W PoE Models	48-56V _{DC}
Power Consumption	5W Max (without PoE Load)
Total PoE Budget	200W Max (model dependent)
PSE Modes	Mode A
PoE Enabled Ports	Ports 1-8 (model dependent)
Protection	Reverse Polarity Overload Current
Fault Relay	Form A 24V @ 1A Max

Packaging.

Shipping Weight	1.01kg / 2.23lb
Dimensions	(W x D x H) 260 x 200 x 60 mm 10.24 x 7.87 x 2.36 in

Mechanical.

Housing	Anodised Aluminium
Dimensions:	(W x D x H) 47 x 106 x 144 mm 1.85 x 4.17 x 5.67 in
Excluding DIN & Wall Mounts	
IP Rating	IP40
Installation	Wall Mount or DIN-Rail
Weight	0.81kg / 1.79lb

Environmental.

Operating Temp.	-40 to +75°C / -40 to +167°F
Storage Temp.	-40 to +85°C / -40 to +185°F
Humidity	5% to 95% (non-condensing)
MTBF	>500,000 hours
MTBF Standard	MIL-HDBK-217F GF 25°C
Heat Dissipation	17 BTU/h (Non-PoE) 700 BTU/h (30W PoE)
Cooling	Passive Cooling
Noise Level	0 dBA

Regulatory.

Safety	IEC/EN 62368-1
EMI	EN 55032 Class A CISPR 32 EN55024 FCC Part 15B Class A
EMS	EN 61000-4-2 (ESD) EN 61000-4-4 (EFT) EN 61000-4-5 (Surge)
Shock	IEC 60068-2-27
Free Fall	IEC 60068-2-32
Vibration	IEC 60068-2-6
Environmental	Reach RoHS WEEE
Traffic	NEMS TS2
Supply Chain	NDAA & TAA Compliant

Designed to meet EN 50121-4

Part Numbers.

8 Port Unmanaged 1Gb Ethernet Switches

AMG350-8G	8x 10/100/1000TX
AMG350-8GAT-P200	8x 10/100/1000TX 30W PoE (200W Max)

Included Accessories.

DIN Rail Adapter Rear Mounted Metal DIN Rail Clip & Screws For DIN Rail Mounting AMG350 Series Products
Wall Mounting Brackets 2x Wall Mounting Brackets & Screws For Wall / Surface Mounting AMG350 Series Products

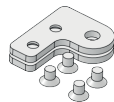
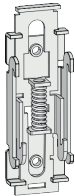

Recommended PSUs.

Non-PoE Models

AMGPSU-W12-P25 Plug Top Mounting Light Industrial Grade PSU, 0 to +70°C, 12VDC, 25W, UK/EU/US Plug Heads Included
AMGPSU-I12-P24 DIN-Rail Mount Industrial Grade PSU, -40 to +70°C, 12VDC, 24W*

PoE Models

AMGPSU-I48-P120 DIN-Rail Mounting Industrial Grade PSU, -40 to +70°C, 47-53VDC, 120W*^
AMGPSU-I48-P240 DIN-Rail Mounting Industrial Grade PSU, -40 to +70°C, 48-53VDC, 240W*^

* Also available in kit form including mains line cord, DC cable and DIN rail. Order with -K at the end of the part code (e.g. AMGPSU-I48-P120-K).
^ Also available with no exposed mains terminals and direct IEC input kit. Order with -IEC at the end of the part code (e.g. AMGPSU-I48-P120-IEC).

Optional Accessories.

AMG2035 Side Mounted Wall Bracket Adapter Kit For DIN Rail Mounting AMG350 Series Products In Depth Restricted Installations.
Adapter Kit Can Be Extended Using The Included Extension Kit To Also Mount A DIN Rail Power Supply Up To 480W

Proud to be a British
Manufacturer 

In a continuing effort to improve and advance technology, product specifications are subject to change without notice. Please visit www.amgsystems.com for the latest product specifications.

AMG Systems Ltd. 4 Pioneer Way, Castleford, WF10 5QU, UK T: +44 (0) 1767 600 777 E: sales@amgsystems.com
AMG Systems Inc. 62 Spring Hill Road, Trumbull, CT 06611, USA T: +1-855-AMGPOE1 (855-264-7631) E: sales@amgsystems.com
D33404-01 amgsystems.com

AMG